

Carew Modus 15

4.2m x 3.6m

Spacious home office suitable for multiple users and uses, for work and hobby space. With a double window opening & large front door opening suitable for bi-folding doors.

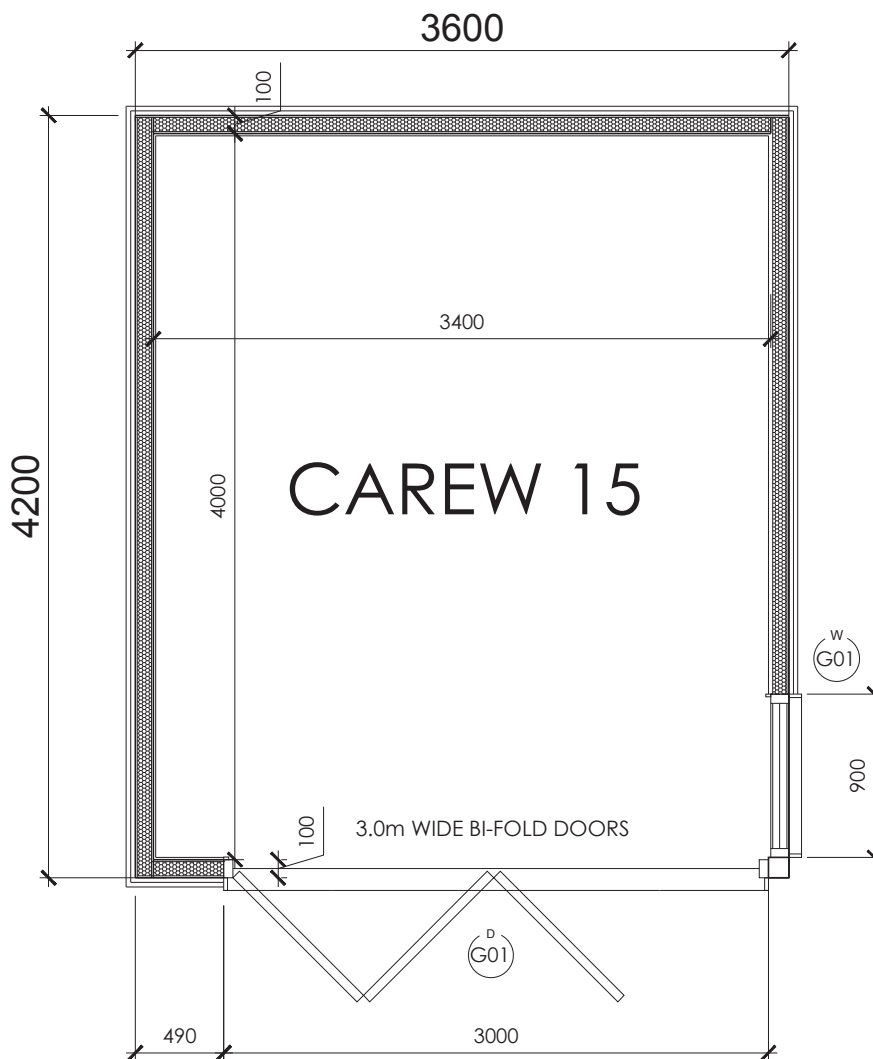

FLOOR PLAN

Shell kit

All Shell kit packages includes the following as standard:

- 100mm machined SIPs panels for floor and walls, includes all window and door openings which are numbered and labelled for easy reference with our installation instructions and “How to” guides.
- 150mm machined SIPs and ready to assemble roof sections.
- All connecting timbers, sole plates, wall plates using treated timber.
- Screws, nails and connecting bolts.
- Polyurethane glue, expanding foam and applicator gun.
- Damp proof membrane
- External breather membrane
- External timber battens.
- EDPM rubber roof kit, including trim
- Packaging, delivery and detailed installation instructions

Shell Enhanced kit

As well as all of the items listed in the ‘shell’ package, the shell enhanced includes:

- Powder-coated aluminium windows and doors, choice of black, grey or white
- External, horizontal larch cladding and fixings.
- All window and door trims.

How it's made

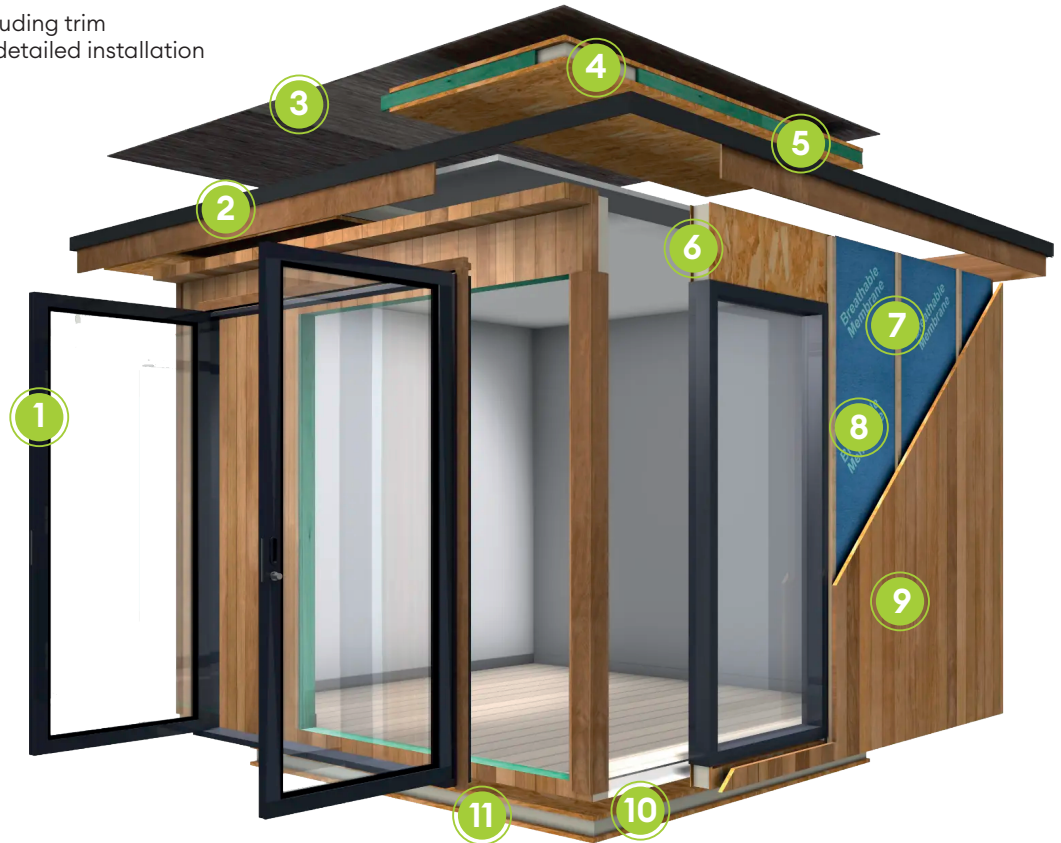

1 Windows & Doors
Powder-coated aluminium window & doors.
Available in black, white and anthracite grey

2 Roof trims
Black plastic roof corner trims

3 Roof covering
EDPM roof covering and shaped with all fixings

4 Roof panels
150mm SIPs - cut with connecting timbers and fixings

5 Edging
Treated timber edging with glue, foam and fixings

6 Wall panels
100mm SIPs - cut with connecting timbers and fixings

7 Battens
Treated timber, battens and fixings

8 Breather membrane
Protects against moisture, regulates temperature,
prevents mould growth, keeps wind and rain out

9 External cladding
High quality vertical larch cladding

10 Floor panels
100mm SIPs - cut with connecting timbers and fixings

11 Sole plates
Treated timber sole plates, pre-cut with all fixings